

# Solutions for Insulating Metal Buildings

## Product Description.

The HIGH-R® Banded Solution is designed to provide excellent thermal performance and a clean, bright finish for both new and existing buildings.

It works by clipping the HIGH-R Quick Attach Clip (patent pending) onto the purlin. This clip is designed with a protruding pin to attach the scrim material. The scrim material is then held in place with the plastic retainer cap which snaps onto the teeth of the purlin clip pin and tack adhesive.

We offer several scrim materials, with various widths and durability to suit any building. All seams are double taped and all edges are taped and banded to ensure complete support and seal.

After attaching the scrim material, certified fiberglass insulation is blown into the cavity between the exterior sheeting and the scrim material. The banded system is supported by 1-3/4" steel bands that are clipped to the structure with the HIGH-R Quick Attach Clips and locked into place with the plastic retainer caps. The steel banding is run twenty-four inches on center perpendicular to the roof purlins. Additional steel banding may be used for deep purlins and custom situations.

Not only does the HIGH-R Banded Solution improve the timeliness of the erection of the structure, but the bottom load system also allows the contractor to quickly install the exterior sheeting to dry out the building and get the project moving forward faster.

## Applications.

- Metal Buildings (walls, ceilings)
- Post Frame Buildings

## Features.

- Class 1 / Class A Fire Rating
- Neat, UV resistant, washable finish
- Improved consistent thermal protection
- Brighter Interior

## HIGH-R® Banded Solution

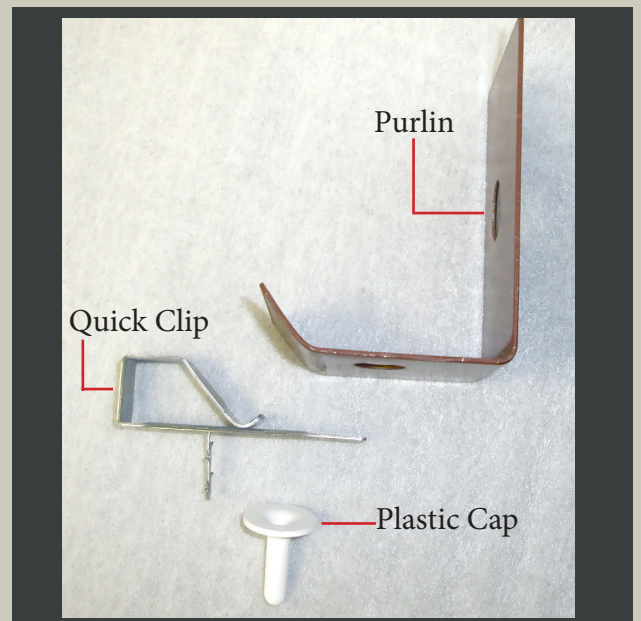
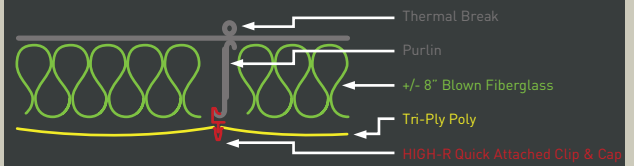

- Outstanding acoustical properties
- Available in Square Edge, Quick Seam or Tab Two
- Cleanable surface
- Approved Flame Spread/ Smoke Development Ratings

2335 230th Street, Ames, IA 50014  
888-595-2763  
[info@high-r.com](mailto:info@high-r.com) | [www.high-r.com](http://www.high-r.com)

Affiliations:

